



# Che cinema!

L'ultima frontiera delle lampade  
Philips Xenon per Cinema



**PHILIPS**

# Lampade Philips Digital Xenon

Le lampade Philips Digital Cinema Xenon sono appositamente progettate per soddisfare i requisiti sempre più elevati dei proiettori cinematografici odierni. Ogni lampada è personalizzata a seconda del modello di proiettore per massimizzarne le prestazioni. Le lampade Philips Digital

Cinema Xenon forniscono una emissione di luce maggiore, necessaria per le rappresentazioni in 3D. Philips lavora a stretto contatto con i principali produttori OEM di proiettori al fine di assicurare che le prestazioni della lampada soddisfino alla perfezione le caratteristiche del proiettore.

Caratteristiche	Vantaggi
Lampada personalizzata a seconda del modello di proiettore	Ottimizzazione delle prestazioni del proiettore
Design avanzato dell'elettrodo	Stabilità dell'arco elevata e durevole
Elevato rendimento luminoso	Elevata brillantezza sullo schermo

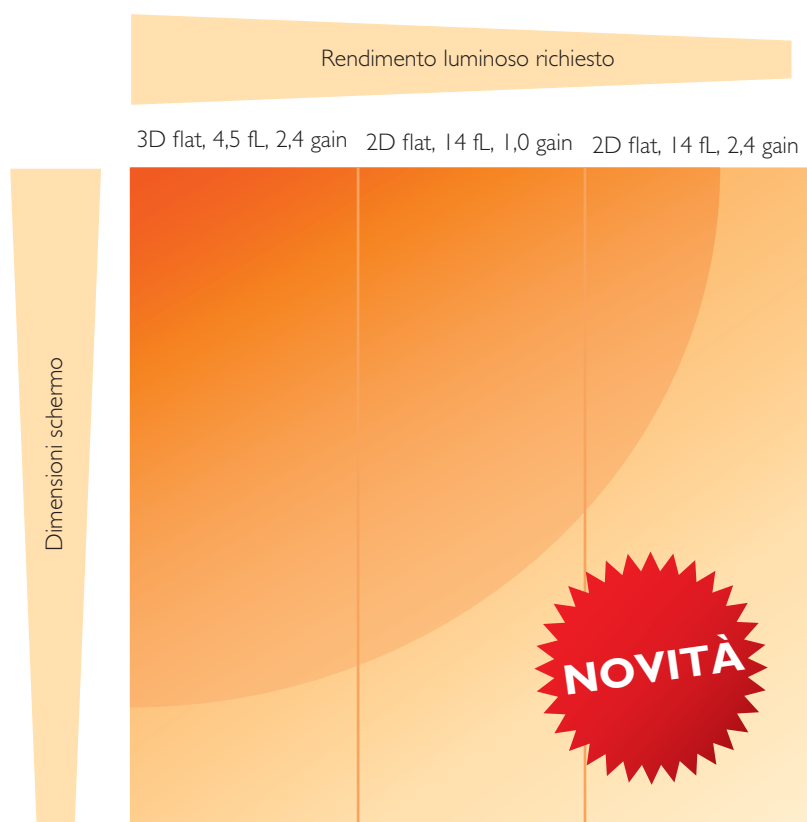

Con le NUOVE lampade Digital Cinema Xenon, abbiamo aumentato ulteriormente il nostro portafoglio, consentendo anche alle applicazioni 2D e/o per piccolo schermo di beneficiare dei vantaggi economici delle lampade della serie Digital, in maniera efficiente dal punto di vista dei costi.

- Philips dispone di tutte le lampade per ogni tipologia di proiettore.
- Philips soddisfa con le **NUOVE lampade** ogni esigenza di applicazione in 2D o 3D per piccolo schermo.

## Strumento di selezione delle lampade

Per aiutarti a scoprire quale sia la lampada Philips Digital Cinema Xenon più economica come costi di gestione e più adatta alle caratteristiche della tua attrezzatura, abbiamo sviluppato uno strumento online per la selezione delle lampade. Vai su [www.philips.com/lighting/entertainment](http://www.philips.com/lighting/entertainment) e in pochi click trovi l'esatta corrispondenza per il tuo impianto. Oppure puoi contattare il nostro ufficio di Milano, fornendo le caratteristiche tecniche della tua sala: ti indicheremo la lampada PHILIPS più adatta al tuo proiettore.

# Lampade Philips Digital Xenon

Prodotto	Potenza (W)	Tensione (V)	Corrente (A)	Min/Max (A)	Tensione innesco (kV)	Cooling (flusso aria m/s)	Posizione funzionamento	Durata (h)	Codice prodotto
Philips XDC-2000BH*	2000	24	80	60/85	35	20	±15 deg	1800	9284 167 06301
Philips XDC-3000B	3000	30	90	60/100	40	20	±15 deg	1500	9284 152 06301
Philips XDC-3000BH*	3000	29	100	60/110	35	20	±15 deg	1200	9284 168 06301
Philips XDC-4000B	4000	33	120	100/130	40	20	±15 deg	1000	9284 151 06301
Philips XDC-4200BH*	4200	29	140	80/160	35	20	±15 deg	700	9284 169 06301
Philips XDC-6500B	6500	38	170	140/175	40	20	±15 deg	500	9284 150 06301
Philips XDC-2000C	2000	25	80	50/90	36	20	±30 deg	2400	9284 133 06301
Philips XDC-3000C	3000	29	110	90/120	36	20	±20 deg	1500	9284 117 06201
Philips XDC-4500C	4500	33	140	120/160	36	20	±15 deg	1000	9284 153 06201
Philips XDC-6000C	6000	40	155	110/160	40	20	±15 deg	600	9284 167 06201
Philips XDC-2000S	2000	25	80	60/95	35	20	±15 deg	2400	9284 134 06301
Philips XDC-3000S	3000	28	100	80/115	35	20	±15 deg	1000	9284 118 06201
Philips XDC-4200S	4200	31	135	80/148	35	20	±15 deg	600	9284 146 06201
Philips XDC-2000NH*	2000	24	80	50/85	40	20	±15 deg	1800	9284 164 06301
Philips XDC-3000NH*	3000	29	100	60/110	40	20	±15 deg	1200	9284 165 06301
Philips XDC-4000N	4000	32	125	105/135	40	20	±15 deg	650	9284 154 06301
Philips XDC-4001N	4000	32	125	100/135	40	20	±15 deg	1500	9284 155 06301
Philips XDC-4200NH*	4200	29	140	80/160	40	20	±15 deg	700	9284 166 06301
Philips XDC-4500N	4500	33	140	100/150	36	20	±15 deg	900	9284 154 06201
Philips XDC-6000N	6000	40	155	110/160	36	20	±15 deg	600	9284 168 06201
Philips XDC-3000TA	3000	29	110	65/120	36	20	±15 deg	1500	9284 158 06301
Philips XDC-4500TA	4500	30	145	80/150	40	20	±15 deg	1000	9284 159 06301
Philips XDC-6000TA	6000	35	170	140/175	40	20	±15 deg	600	9284 149 06301
Philips XDC-6500TA	6500	38	170	140/175	40	20	±15 deg	500	9284 146 06301

Prodotto	Lunghezza				Diametro				Arc/gap (mm)
	A	B	C	D	E	F	G	H	
	distanza (mm)	length max (mm)	length max (mm)	diametro (mm)	Lead Length	Anode/athode Base Dia	Anode pin diameter	Cathode pin dia or thread type	
Philips XDC-2000BH*	123	294	341	46	140	27	13.9	M12 x 1.75	4.9
Philips XDC-3000B	123	294	341	55	132	27	13.9	M12 x 1.75	4.4
Philips XDC-3000BH*	123	294	341	52	140	27	13.9	M12 x 1.75	6.0
Philips XDC-4000B	123	294	341	60	132	27	13.9	M12 x 1.75	6.1
Philips XDC-4200BH*	170.5	391	433	62	152	30	9.4	7.9	7.0
Philips XDC-6500B	170.5	391	433	70	152	30	9.4	7.9	7.5
Philips XDC-2000C	161.5	350	403	55	-	27	14	M14 x 1.50	4.4
Philips XDC-3000C	161.5	350	403	60	-	28	14	M14 x 1.50	5.5
Philips XDC-4500C	165.5	381	417	70	-	30	14	M14 x 1.50	6.0
Philips XDC-6000C	165.5	381	417	70	-	30	14	M14 x 1.50	8.0
Philips XDC-2000S	128	295	336	60	203	28/30	14	20	3.9
Philips XDC-3000S	128	295	336	60	203	28/30	14	20	4.1
Philips XDC-4200S	128	295	332	60	-	28/30	14	20	4.2
Philips XDC-2000NH*	144	306	336	46	160	28/27	14	20	4.9
Philips XDC-3000NH*	144	306	336	52	160	28/27	14	20	6.0
Philips XDC-4000N	144	306	336	60	160	28/27	14	20	4.9
Philips XDC-4001N	144	306	336	60	160	27	14	20	6.8
Philips XDC-4200NH*	171.5	387	425	62	220	30	14	20	7.0
Philips XDC-4500N	171.5	387	425	70	220	30	14	20	6.0
Philips XDC-6000N	171.5	387	425	70	220	30	14	20	7.5
Philips XDC-3000TA	145	302	342	55	400	27	9.4	7.8	5.0
Philips XDC-4500TA	171	370	410	60	400	30	9.4	7.9	6.0
Philips XDC-6000TA	170.5	391	433	70	400	30	9.4	7.9	7.0
Philips XDC-6500TA	170.5	391	433	70	400	30	9.4	7.9	7.5





## Lampade Philips Digital Cinema Xenon

Marca Proiettore	Modello Proiettore	Watt Lampada	Lampada Philips
Barco	DP2K-32B	6.5K	Philips XDC-6500B
	DP4K-32B		
	DP-90		
	DP-100		
	DP-3000		
	DP2K-32B		
	DP4K-32B	4.2K	Philips XDC-4200BH*
	DP-90		
	DP-100		
	DP-3000		
	DP2K-20C		
	DP2K-23B		
DP4K-23B	4K	Philips XDC-4000B	
DP-1500			
DP-2000			
DP2K-15C			
DP2K-19B			
DP2K-20C			
DP2K-23B	3K	Philips XDC-3000B	
DP-1500			
DP-2000			
DP2K-15C			
DP2K-19B			
DP2K-20C			
DP2K-23B	3K	Philips XDC-3000BH*	
DP-1500			
DP-2000			
DP2K-12C			
DP2K-15C			
DP2K-19B			
DP2K-20C	2K	Philips XDC-2000BH*	
DP2K-23B			
DP-1200			
DP-1500			
DP-2000			

Marca Proiettore	Modello Proiettore	Watt Lampada	Lampada Philips
Christie	CP2000-SB	6K	Philips XDC-6000C
	CP2230		
	CP4230		
	CP2000-SB	4.5K	Philips XDC-4500C
	CP2230		
	CP4230		
	CP2000-SB	3K	Philips XDC-3000C
	CP2000-XB		
	CP2000-ZX		
	CP2220		
	CP2230		
	CP4220		
CP4230	2K	Philips XDC-2000C	
CP2000-SB			
CP2000-XB			
CP2000-ZX			
CP2220			
CP2230			
CP4220			
CP4230	NEC	6K	Philips XDC-6000N
NC2500S			
NC3200S			
NC3240S		4.5K	Philips XDC-4500N
NC2500S			
NC3200S			
NC3240S		4.2K	Philips XDC-4200NH*
NC2500S			
NC3200S			
NC3240S		4K	Philips XDC-4001N
NC1600C			
NC2000C			
NC1600C	4K	Philips XDC-4000N	
NC2000C			
NC1600C			
NC2000C	3K	Philips XDC-3000NH*	
NC1600C			
NC2000C			
NC1600C	2K	Philips XDC-2000NH*	
NC2000C			
NC3240S			
Sony	SRX-R220	4.2K	Philips XDC-4200S
	SRX-R320		
	SRX-R220	3K	Philips XDC-3000S
	SRX-R320		
SRX-R220	2K	Philips XDC-2000S	
SRX-R320			

\* **Novità**

# Lampade Philips Helios® Xenon

	(W)	(V)	rente (A)	in uscita	Max (A)	innesco (kV)	(flusso aria m/s)	funzionamento		(h)	prodotto
Philips LTIX-2000W-HEH	2000	27	70	80.000	50/85	36	20	+/- 20 deg	-	1800	9284 137 06301
Philips LTIX-2000W-HEHS	2000	24	80	80.000	50/85	36	20	+/- 30 deg	-	1800	9284 138 06301
Philips LTIX-2000W-HETP	2000	27	70	80.000	50/85	36	20	+/- 30 deg	-	1800	9284 140 06301
Philips LTIX-2005W-HEH	2000	27	70	80000	50/85	36	20	± 20 deg	-	1800	9284 157 06301
Philips LTIX-2005W-HEHS	2000	24	80	80000	50/85	36	20	± 30 deg	-	1800	9284 156 06301
Philips LTIX-2005W-HETP	2000	27	70	80000	50/85	36	20	± 30 deg	-	1800	9284 107 06201
Philips LTIX-2500W-HEH	2500	29	83	105000	60/95	36	20	± 30 deg	-	1200	9284 111 06201
Philips LTIX-2500W-HEHS	2500	28	90	105000	60/95	36	20	± 30 deg	-	1200	9284 112 06201
Philips LTIX-3000W-HEH	3000	29	100	130.000	60/110	36	20	+/- 30 deg	-	1200	9284 121 06201
Philips LTIX-3000W-HEHS	3000	29	100	130.000	60/110	36	20	+/- 30 deg	-	1200	9284 122 06201
Philips LTIX-3000W-HETP	3000	29	100	130.000	60/110	36	20	+/- 30 deg	-	1200	9284 124 06201
Philips LTIX-3005W-HEHS	3000	29	100	130.000	60/100	36	20	+/- 30 deg	-	1200	9284 135 06201
Philips LTIX-3005W-HETP	3000	29	100	130.000	60/110	36	20	+/- 30 deg	-	1200	9284 136 06201
Philips LTIX-4200W-HEH	4200	29	140	190.000	80/160	36	20	+/- 20 deg	required	700	9284 149 06201
Philips LTIX-4200W-HETP	4200	29	140	190.000	80/160	36	20	+/- 20 deg	required	700	9284 150 06201
Philips LTIX-4201W-HEH	4200	29	140	190.000	80/160	36	20	+/- 20 deg	required	700	9284 151 06201
Philips LTIX-4202W-HEHS	4200	29	140	190.000	80/160	36	20	+/- 20 deg	required	700	9284 152 06201
Philips LTIX-7000W-HEH	7000	41	160	350.000	110/165	44	20	+/- 15 deg	-	600	9284 181 06201
Philips LTIX-7000W-HEHS	7000	41	160	350.000	110/165	44	20	+/- 15 deg	horizontal required	600	9284 182 06201

Prodotto	Lunghezza				Diametro				Arc gap (mm)
	A	B	C	D	E	F	G	H	
	distanza (mm)	lunghezza max (mm)	lunghezza max (mm)	diametro (mm)	lead length	Anode/Cathode base diameter (mm)	Anode pin diameter (mm)	Cathode pin diameter (mm) or thread type	
Philips LTIX-2000W-HEH	142,5	322	366	46	305	27	9,9	11,9	5,7
Philips LTIX-2000W-HEHS	145	302	337	46	280	27	9,4	7,8	5,0
Philips LTIX-2000W-HETP	142	320	365	46	-	25	14	M14 x 1,5	5,7
Philips LTIX-2005W-HEH	167,5	382	424	46	280	27	13	14	5,7
Philips LTIX-2005W-HEHS	145	302	337	46	280	27	9,4	7,8	5,0
Philips LTIX-2005W-HETP	161,5	350	394	46	None	28	14	M14x1,5	5,7
Philips LTIX-2500W-HEH	167,5	382	428	52	280	27	13	14	6,0
Philips LTIX-2500W-HEHS	145	302	337	52	280	27	9,4	7,8	6,0
Philips LTIX-3000W-HEH	167,5	382	428	52	280	27	13	14	6,0
Philips LTIX-3000W-HEHS	145	302	337	52	280	27	9,4	7,8	6,0
Philips LTIX-3000W-HETP	161,5	350	394	52	-	28	14	M14 x 1,5	6,0
Philips LTIX-3005W-HEHS	171	370	410	52	305	30	9,4	7,8	6,0
Philips LTIX-3005W-HETP	166,5	380	424	52	-	28	14	M14 x 1,5	6,0
Philips LTIX-4200W-HEH	167,5	382	428	62	305	27	13	14	7,0
Philips LTIX-4200W-HETP	167,5	382	428	62	-	27	14	M14 x 1,5	7,0
Philips LTIX-4201W-HEH	167,5	382	428	62	305	30	15,8	18	7,0
Philips LTIX-4202W-HEHS	171	370	410	62	305	30	9,4	7,8	7,0
Philips LTIX-7000W-HEH	170	382	428	70	305	27	13	14	11,0
Philips LTIX-7000W-HEHS	170,5	393	437	70	305	30	9,4	7,9	11,0

**Nome Prodotto    Abbreviazione**

<b>HE</b>	Helios®
<b>HEH</b>	Helios® standard lamp
<b>HEHS</b>	Short Helios®
<b>HETP</b>	Helios® lamp with threaded pin

# Lampade Philips Standard Xenon

Prodotto	Potenza (W)	Tensione (V)	Corrente (A)	Lumen In uscita	Min/Max (A)	Tensione innesco (kV)	Cooling (flusso aria m/s)	Posizione funzionamento	Magnete	Durata (h)	Codice prodotto
Philips LTIX-700W-HS	700	18	37	20.000	30/45	33	20	+/- 20 deg v/h	-	1500	9284 103 06301
Philips LTIX-700W-HSC	700	18	37	20.000	30/45	33	20	+/- 20 deg v/h	-	1500	9284 104 06301
Philips LTIX-1000W-HS	1000	19	50	32.000	30/55	33	20	+/- 20 deg v/h	-	1500	9284 107 06301
Philips LTIX-1000W-HSC	1000	19	50	32.000	30/55	33	20	+/- 20 deg v/h	-	1500	9284 108 06301
Philips LTIX-1000W-HTP	1000	21	45	35.000	30/55	33	20	+/- 30 deg v/h	required	2400	9284 109 06301
Philips LTIX-1600W-H	1600	24	65	60.000	45/75	33	20	+/- 30 deg v/h	-	2400	9284 120 06301
Philips LTIX-1600W-HC	1600	24	65	60.000	45/75	33	30	+/- 30 deg v/h	-	2400	9284 121 06301
Philips LTIX-1600W-HS	1550	23	65	60.000	50/70	33	20	+/- 20 deg v/h	-	1500	9284 122 06301
Philips LTIX-1600W-HSC	1550	23	65	60.000	50/70	33	20	+/- 20 deg v/h	-	1500	9284 124 06301
Philips LTIX-2000W-H	2000	27	70	80.000	50/85	36	20	+/- 30 deg v/h	horizontal required	2400	9284 135 06301
Philips LTIX-2000W-HC	2000	27	70	80.000	50/85	36	20	+/- 30 deg v/h	horizontal required	2400	9284 136 06301
Philips LTIX-2000W-HS	2000	24	80	80.000	50/85	36	20	+/- 30 deg v/h	-	2400	9284 141 06301
Philips LTIX-2000W-HTP	2000	27	70	80.000	50/85	36	20	+/- 30 deg v/h	horizontal required	2400	9284 142 06301
Philips LTIX-2000W-HTT	2000	24	80	80.000	50/85	36	20	+/- 20 deg v/h	-	2400	9284 143 06301
Philips LTIX-2000W-SHSC	2000	27	70	80.000	50/85	36	20	+/- 20 deg v/h	-	2400	9284 144 06301
Philips LTIX-2500W-H	2500	29	83	100.000	60/95	36	20	+/- 30 deg v	-	1800	9284 110 06201
Philips LTIX-2500W-HS	2500	28	90	100.000	70/100	36	20	+/- 30 deg v/h	-	1500	9284 114 06201
Philips LTIX-3000W-H	3000	29	100	130.000	60/100	36	20	+/- 30 deg v/h	required	1500	9284 119 06201
Philips LTIX-3000W-HC	3000	29	100	130.000	60/100	36	20	+/- 30 deg v/h	required	1500	9284 120 06201
Philips LTIX-3000W-HS	3000	29	100	130.000	60/110	36	20	+/- 30 deg v/h	required	1500	9284 125 06201
Philips LTIX-3000W-HTP	3000	29	100	130.000	60/110	36	20	+/- 30 deg v/h	horizontal required	1500	9284 126 06201
Philips LTIX-4000W-HTP	4000	30	130	155.000	100/140	36	20	+/- 20 deg v/h	-	1200	9284 141 06201
Philips LTIX-4200W-H	4200	29	140	190.000	80/160	36	20	+/- 20 deg v/h	-	1000	9284 147 06201
Philips LTIX-4200W-HC	4200	29	140	190.000	80/160	36	20	+/- 20 deg v	-	1000	9284 148 06201
Philips LTIX-4500W-HS	4000	29	135	155.000	80/150	36	20	+/- 30 deg v/h	horizontal required	1000	9284 155 06201
Philips LTIX-4500W-HTP	4500	30	150	155.000	80/150	36	20	+/- 15 deg v/h	horizontal required	1000	9284 156 06201
Philips LTIX-5000W-H	5000	33	140	225.000	100/150	36	20	+/- 15 deg v/h	required	1000	9284 158 06201
Philips LTIX-5000W-HS	5000	33	140	225.000	100/150	36	20	+/- 15 deg v/h	horizontal required	800	9284 160 06201
Philips LTIX-5001W-H	5000	33	140	225.000	100/150	36	20	+/- 15 deg v/h	horizontal required	800	9284 162 06201
Philips LTIX-5002W-H	5000	33	140	225.000	100/150	36	20	+/- 15 deg v/h	horizontal required	800	9284 164 06201
Philips LTIX-6000W-HS	6000	37	160	320.000	110/165	44	20	+/- 15 deg v/h	horizontal required	500	9284 169 06201
Philips LTIX-6000W-HTP	6000	37	160	320.000	110/165	44	20	+/- 15 deg v/h	horizontal required	500	9284 170 06201
Philips LTIX-6002W-HS	6000	37	160	350.000	110/165	44	20	+/- 15 deg v/h	required	500	9284 173 06201
Philips LTIX-6500W-H	6500	40	160	325.000	80/160	44	20	+/- 15 deg v/h	required	500	9284 178 06201
Philips LTIX-7000W-H	7000	41	160	350.000	110/165	44	20	+/- 15 deg v/h	-	600	9284 180 06201
Philips LTIX-7000W-HS	7000	41	160	350.000	110/165	44	20	+/- 15 deg v/h	horizontal required	600	9284 183 06201
Philips LTIX-10000W-HS	10000	50	200	510.000	190/210	45	33	+/- 15 deg v/h	horizontal required	500	9284 191 06201

**Nome Prodotto    Abbreviazione**

<b>H</b>	orizzontale
<b>HC</b>	orizzontale con cavo
<b>HS</b>	lampada corta
<b>HSC</b>	lampada corta con cavo
<b>HTP</b>	lampada con perno filettato
<b>HTT</b>	filetto su entrambi i lati
<b>SHSC</b>	super lampada corta

# Lampade Philips Standard Xenon

Prodotto	Lunghezza				Diametro				Arc gap (mm)
	A	B	C	D	E	F	G	H	
	distanza (mm)	lunghezza max (mm)	lunghezza max (mm)	diametro (mm)	lead length	Anode/Cathode base diameter (mm)	Anode pin diameter (mm)	Cathode pin diameter (mm) or thread type	
Philips LTIX-700W-HS	95	205	234	40	-	27	11	5/16-18UNC-2A	3.2
Philips LTIX-700W-HSC	95	205	234	40	254	27	-	5/16-18UNC-2A	3.2
Philips LTIX-1000W-HS	95	205	234	40	-	27	11	5/16-18UNC-2A	3.5
Philips LTIX-1000W-HSC	95	205	234	40	254	27	-	5/16-18UNC-2A	3.5
Philips LTIX-1000W-HTP	121.5	275	328	46	-	25	14	M14 x 1.5	5.0
Philips LTIX-1600W-HS	95	205	234	46	-	27	11	5/16-18UNC-2A	4.0
Philips LTIX-1600W-HSC	95	205	234	46	254	27	-	5/16-18UNC-2A	4.0
Philips LTIX-1600W-H	142.5	322	370	52	-	27	10	12	4.8
Philips LTIX-1600W-HC	142.5	322	370	52	280	27	10	12	4.8
Philips LTIX-2000W-H	142.5	322	370	52	280	27	10	12	5.8
Philips LTIX-2000W-HC	142.5	322	370	52	280	27	10	12	5.8
Philips LTIX-2000W-HS	145	302	337	60	280	27	9.4	7.8	5.0
Philips LTIX-2000W-HTP	142	320	365	52	-	25	14	M14 x 1.5	6.0
Philips LTIX-2000W-HTT	142.5	322	373	52	-	25	10	M10 x 1.25	6.0
Philips LTIX-2000W-SHSC	95	205	234	46	254	27	-	5/16-18UNC-2A	5.0
Philips LTIX-2500W-H	167.5	382	424	60	280	27	13	14	7.0
Philips LTIX-2500W-HS	145	302	337	60	280	27	9.4	7.8	5.5
Philips LTIX-3000W-H	167.5	382	424	60	280	27	13	14	7.0
Philips LTIX-3000W-HC	167.5	382	424	60	280	27	13	14	7.0
Philips LTIX-3000W-HS	145	302	337	60	280	27	9.4	7.8	6.0
Philips LTIX-3000W-HTP	161.5	350	394	60	-	28	14	M14 x 1.5	7.0
Philips LTIX-4000W-HTP	166.5	380	428	70	-	28	14	M14 x 1.5	7.1
Philips LTIX-4200W-H	167.5	382	428	70	305	27	13	14	7.1
Philips LTIX-4200W-HC	167.5	382	428	70	305	27	13	14	7.1
Philips LTIX-4500W-HS	171	370	410	70	305	30	9.4	7.8	7.0
Philips LTIX-4500W-HTP	166.5	380	424	70	-	28	14	M14 x 1.5	7.8
Philips LTIX-5000W-H	167.5	382	428	70	305	30	16	18	8.0
Philips LTIX-5000W-HS	171	370	410	70	305	30	9.4	7.8	8.0
Philips LTIX-5001W-H	167.5	382	428	70	305	27	13	14	8.0
Philips LTIX-5002W-H	168	382	426	70	305	30	9.4	7.8	7.5
Philips LTIX-6000W-HS	170.5	370	414	78	305	30	9.4	7.8	9.0
Philips LTIX-6000W-HTP	165.5	381	417	78	-	30	14	M14 x 1.5	9.0
Philips LTIX-6002W-HS	170.5	393	437	78	381	30	9.4	7.8	9.0
Philips LTIX-6500W-H	200	434	480	78	305	30	20	22	11.5
Philips LTIX-7000W-H	170	382	427	78	305	27	13	14	11.0
Philips LTIX-7000W-HS	170.5	393	436	78	305	30	9.4	7.8	11.0
Philips LTIX-10000W-HS	170	390	433	90	457	30	9.4	14	13.7

# Caratteristiche fotometriche lampade PHILIPS

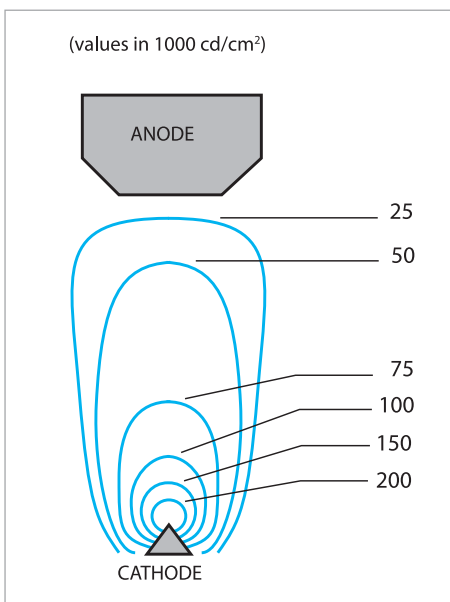
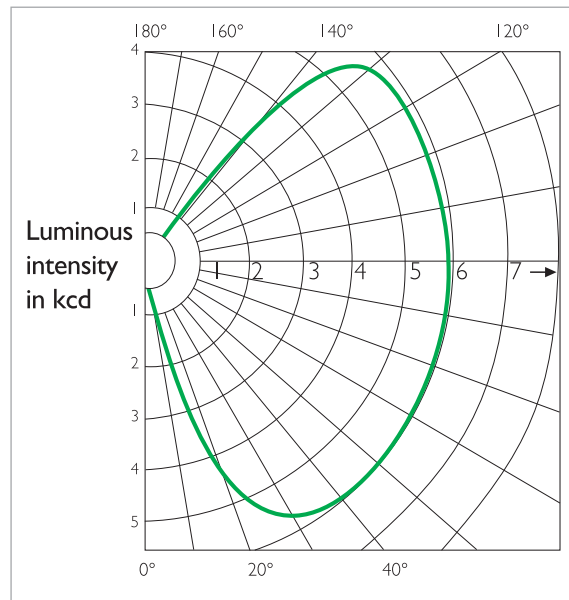
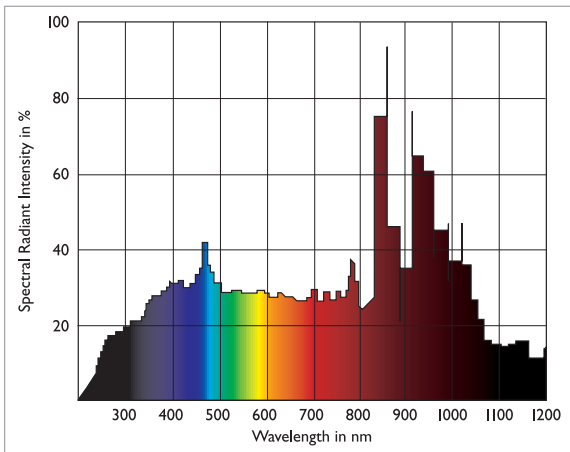

Luminous intensity

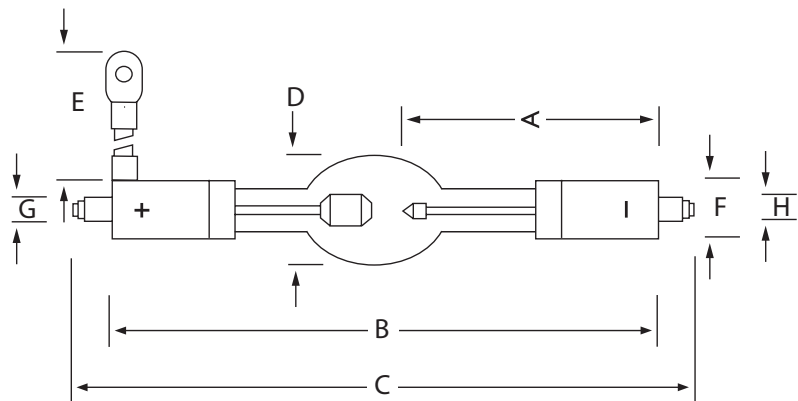

Misure Lampada

I.P.

Distributore ufficiale in Italia:

**GUIDO AMMIRATA S.R.L.**  
**LAMPADINE SPECIALI**

Via Marocco, 13 - 20127 Milano (Italia)  
 Tel. +39 02 2820646 - Fax +39 02 2894660  
 ammirata@kqnet.it - www.ammirata.it

